

# GETTING STARTED

## Keychain Remote

Your Keychain Remote has already been pre-programmed. It's ready to go right out of the box, so you can start managing your home's safety on the go.

- 1 Lock** – Press *once* to arm in Stay Mode (arms Door and Window and Glass Break Sensors) and *twice* to arm in Away Mode (arms all sensors).
- 2 Unlock** – Press *once* to disarm your system.
- 3 Lights** – Press *once* to turn on or off all lights connected to your system.
- 4 Panic** – Press the Lock and UnLock buttons *together* for 3 seconds to initiate a panic alarm.

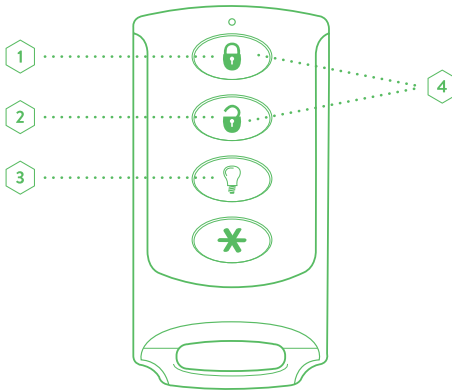

*\*For any button, press and hold for 1-2 seconds in order for a signal to be sent.*

**NEED HELP? [WWW.FRONTPOINT.COM/HELP](http://WWW.FRONTPOINT.COM/HELP)**